

OREGON CENTURY FARM & RANCH PROGRAM
2018 Applicant Approval Checklist

Name of applicant Seven & Gretchen Jones

Name of Farm or Ranch Select Seed Promised LLC County Yamhill

Notarized yes ___ no Posted by May 1 yes ___ no \$250 Application yes ___ no

Other fees (additional certificates, @ \$20 ea.), amount \$ —

Total fees pd. \$ 250

1. Applicant is legal owner yes ___ no other _____

2. 100 years of continuous operation by same family yes ___ no

Comments _____

3. Not less than \$1,000 gross income per year for three out of last five years yes ___ no

Comments _____

4. Living on or actively managing and directing the farming or ranching activity on the land yes ___ no

Comments _____

5. Line of ownership from original settler or buyer through children, siblings, nephews or nieces. Adopted children will be recognized equally with other descendants yes ___ no

6. Official form used with all questions answered completely, including narrative yes ___ no

Comments short (incomplete)

7. Documentation showing the date of earliest ownership (Donation Land Claim, Deed of Sale, Homestead Certificate, Family Bible, diary entry, or correspondence) yes ___ no

Comments _____

Photos included with application yes ___ no Sent digital photos ___ yes no

Additional information needed from applicant photo, digitally, narr. revision

sign order form

Concerns or questions _____

Application Approval/Reviewer Notes Identification of Family Stories for Narratives:

Reviewer #1: Initials gd

Notes: *Good application
Personally know Family
Ryan has been a York Co FB Board for over 10 years*

Reviewer #2: Initials: MFBattista

Notes: *Good succession*

Reviewer #3: Initials: JRW

Notes: *Great pictures, Awesome to see a legacy preserved.*

Reviewer #4: Initials: _____

Notes:

Reviewer #5: Initials: _____

Notes:

Provide at meeting:

- Blank copies of applications
- Copies of drafted narratives sent on hand
- Print digital pictures for review if only send digital
- Model "Timeline" added to application materials for applicants * This was not done, will do in 2016

A program of the Oregon Agricultural Education Foundation

Oregon Century Farm & Ranch Program Application

Date 4-26-2018

Type of designation (please check) Century Farm Century Ranch

Legal owner / Applicant name Steven R + Gretchen Jones

Farm or Ranch Name Select Seed Promised LLC

Mailing address of Legal Owner / Applicant **Redacted For Privacy**

Telephone **Redacted For Privacy** E-mail address **Redacted For Privacy**

Contact name (if different than legal owner) _____

Mailing address of contact _____

Contact telephone _____ E-mail address _____

Location of farm or ranch (which is the subject of this application):

County **Redacted For Privacy**

Distance 4 miles from nearest town Amity

Township 5S Range 5W Section 23

Address or physical location of the farm or ranch (which is subject of this application)

Redacted For Privacy

GPS (Global Positioning System) Coordinates, if known **Redacted For Privacy**

Please attach a map or drawing showing the location of the eligible property within the context of the family farm or ranch.

(Continue application on next page)

Oregon Century Farm & Ranch Program Application - Continued

Founder(s):

Original family owner(s) or founder(s) Henry W + Minta W. Jones

Date (year) this farm or ranch was acquired by founder(s) Dec. 7, 1918
(Attach verifying documentation. See Application Qualification #7)

Who farms or ranches the land today? Steven R + Gretchen K Jones

Relationship of applicant to original owner. Clearly explain lineage from original ownership documents to current applicant. (See Application Qualification #7)

Grand son

If the farm or ranch has ever been rented or leased, please explain the owner's role in this relationship. For example, is the owner actively involved in the management of the land?

farm is now leased to our son + daughter-in-law
Ryan L + Stacie Jones

History of buildings:

Are any of the original buildings still in use? Yes No

When was the first house built? If it is still in use, describe the changes that have been made.

When was the first barn built? Is it still standing?

Yes but has been remodeled
not sure when build

When were other structures built (examples: silos, machine shops, coops, smokehouses, dryers, etc.). Describe the changes that have been made.

grain tanks - 1970
storage shed - 1972
seed cleaning building - 1978
pit silo - 1972
Addition to original barn - 1998
bulk storage building - 2008
upgraded grain tank - 2011

(Continue application on next page)

Oregon Century Farm & Ranch Program Application – Continued

Are any of the buildings listed on the National Register of Historic Places?
If, "yes", please describe and note the listed name of the property here:

Yes

No

History of crops or livestock raised on farm or ranch:

What were the early crops or livestock?

draft horses

sheep

goats

milk cows

annual rye grass

peas

vetch

wheat

malting barley

red clover

crimson clover

How many acres were included in original farm or ranch?

600

How did the crops / livestock / use of farm or ranch change over the years?

Our main crop is now turf-type tall fescue
with a wheat + oat rotation

We also have a small hazelnut orchard

What are crops / livestock raised on the subject farm or ranch today?

turf-type tall fescue

hazelnuts

oats

wheat

How many acres does the subject farm or ranch include today?

400 A

How many acres are in agricultural use today?

380 A

(Continue application on next page)

Oregon Century Farm & Ranch Program Application – Continued

The family:

How many generations live on the farm or ranch today?

one

List names and birth years:

Steven R Jones 1949

Submit two or three pages of family history narrative, including, but not limited to generational transfers of the farm or ranch. Please also submit historical & current photos of the property & family, if available. Digital format photos (at highest resolution [300 dpi]) are particularly desirable, so that they may be used in publications, the CF&R Program Database or the web site. Submitted information, including photos, will be deposited in the OSU Libraries – Special Collections & Archives Research Center for future reference. Please send digital photos included with your application to cfr@oregonfb.org by **May 1**.

Type of information to include in your family history narrative:

- Where founder(s) may have moved from to farm or ranch
- Significant events in the family (births, deaths, marriages, etc.)
- Any major changes to operations (methods of production, etc.)
- Additional information on crops, buildings, other changes from the original farm or ranch

(Continue application on next page)

Oregon Century Farm & Ranch Program
Oregon Agricultural Education Foundation
3415 Commercial Street SE, Salem, OR 97302
503-400-7884 or cfr@oregonfb.org

Statement of Affirmation

I, Steven R Jones

hereby affirm and declare that the farm or ranch which I own at Redacted For Privacy
Redacted For Privacy, in the County of Yamhill

has been owned by my family for at least 100 continuous years, as specified in the qualifications for the Century Farm & Ranch Program, on or before December 31 of the current calendar year. Further, I hereby affirm that this property meets all other requirements for Century Farm or Ranch honors, including that the farm or ranch has a gross income from farming or ranching activities of not less than \$1,000 per year for three out of the five years immediately preceding making this statement. I understand that the application materials will become property of the OSU Libraries – Special Collections & Archives Research Center and be made available for public use. By signing below, I understand that I am consenting to the use of both information and photographs.

[Signature]
Signature of Owner

4-27-18
Date

Certification by Notary Public

State of Oregon County of Redacted For Privacy

Be it remembered, that on this 27th day of April, 2018, before me, the undersigned, a Notary Public in and for said county and state, personally appeared the within named Steven R. Jones, known to me to be the identical individual described in and who executed the within instrument and acknowledged to me that Steven R. Jones executed the same freely and voluntarily.

In Testimony Whereof, I have set my hand and affixed my official seal the day and year last above written.

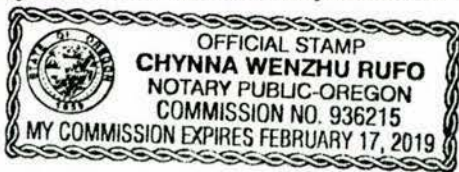

[Signature]
Notary Public for Oregon
My Commission Expires Feb 17, 2019

Fees

Application Fee
(includes one certificate & roadside sign) \$ 250.00
Additional Certificates (\$20 each) \$ _____
Additional Signs (\$200 each) \$ _____
Total Enclosed \$ 250⁰⁰

For office use only

Date Received _____
Approved? Yes No
Authorization _____
Oregon Century Farm & Ranch Program Coordinator

Make checks payable to: Oregon Agricultural Education Foundation or OAEF

In December of 1918, Henry W. Jones & his wife Minta purchased the farm along the South Yamhill River four miles west of Amity, where four generations have since farmed the land. They moved from Henry's father's original homestead, which William T. Jones established in 1847 in the foothills about 7 miles southwest of McMinnville. This was an area known as Muddy Valley, where there was an abundance of forage grass & water, which worked well for livestock raising. The present farm location is much better suited for raising crops. Excellent soils, farm drainage, and irrigation water from the South Yamhill River make for a highly productive farm today.

Henry Jones died in 1939 and their son Russell & wife Harriet Jones moved to the farm. Minta later relocated to McMinnville. Russell and Harriet raise their 6 children and continued to improve the farm and build a new house in 1951. Oldest son William bought a neighboring farm north of the Jones farm in about 1960.

In 1970 Russell and Harriet Jones retired to live part time in Arizona, and their youngest son Steven rented the property, buying the farm in Sept. of 1973. Steven married Gretchen a few months later and have resided there since, raised their four children. In 2011 their oldest son Ryan began to rent part of the farm and this past year has begun renting the entire home place, with wife Stacie and their children, Nathan and Lindsey. Steve & Gretchen are making plans to relocate and Ryan's family will move to the farm in the near future.

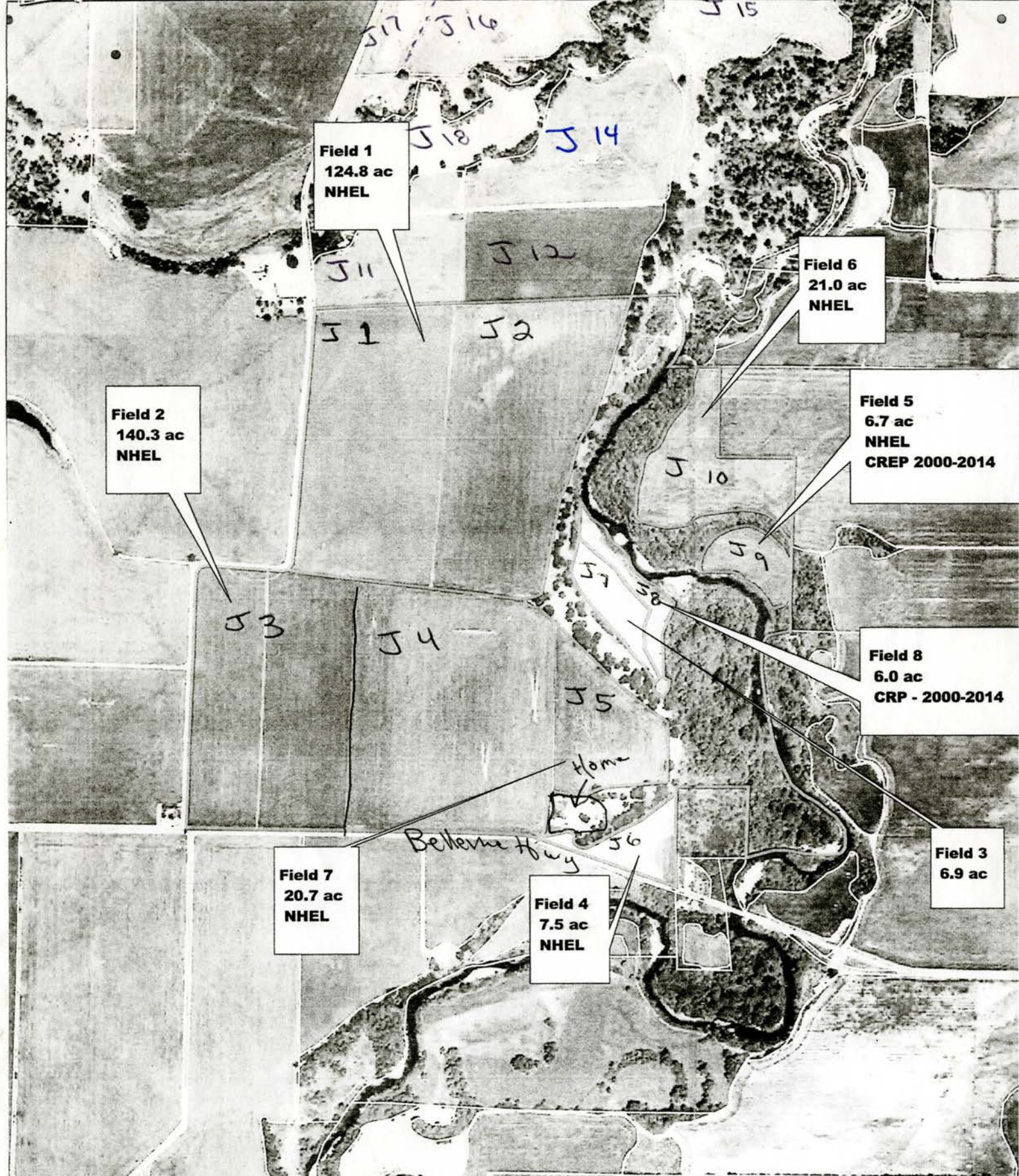

**Tract 1122 - Owner: Steve & Gretchen Jones
Yamhill County**



Legend

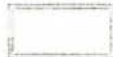

Tract/Field Boundary



Wetland

This acreage is for FSA program purpose only. No warranty is made for any other use.

600 0 600 1200 1800 Feet



WARRANTY DEED

William Taggart Wilson, unmarried

Dated Dec. 7, 1918

To

Recorded Dec. 7, 1918

Book 75 Deeds page 61

Consideration \$48000.00

Henry W. Jones and
Minta W. Jones husband & wife

Signature is sealed

Names of Witnesses: R. L. Conner and Alma Stow

Acknowledged before: R.L. Conner, N.P. Yamhill Co. Or. Dec. 7, 1918; Regular

Covenants: Owner in fee; free from incumbrances; warrant and defend.

Premises

Do bargain, sell and convey the following described premises, to-wit:
Being a part of the D.L.C. of Robert Henderson and Rhoda Henderson,
his wife, Notification No. 2383, Claim No. 49 in Township 5 South of
Range 5 West, and a part of the D.L.C. of Miriam Payne, Notification
No. 2988, Claim No. 73 in Township 5 South of Range 5 West, and Lots
Numbered 5, 6 and 7 of Section 23 in said Township and Range, and more
particularly described as follows, to-wit:

Beginning at a stake set on the East boundary line of the Miriam
Payne Donation Land Claim, Notification No. 2988, Claim No. 73 in T.5
S.R.5 W. of the Willamette Meridian in Yamhill County, Oregon, at a point
14.50 chains North of the most Easterly South East corner of said Miriam
Payne D.L.C., and running thence North 28.41 chains to corner in Yamhill
River on the South boundary line of the D.L.C. of Robert Henderson and
wife; thence South 84° 45' East 14.55 chains to the South East corner of
said Henderson D.L.C.; thence North along the East line of said Henderson
D.L.C. 21.37 chains to the South East corner of a 10.50 acre tract of land
described in deed executed by Robert Henderson and wife to Alexander
Sutton and recorded at page 435 of Book "M" Records of Deeds for Yamhill
County, Oregon; thence West 9.37 chains to the South West Corner of said
10.50 acre tract; thence North 11.03 chains to stake set on South line of
a 49.95 acre tract of land described in deed executed by Robert Henderson
and wife to John J. Henderson of date April 16th, 1866, and recorded at
page 201 of Book "H" of the Records of Deeds for Yamhill County, Oregon;
thence West 1.30 chains to the South West corner of said 49.95 acre tract;
thence North along the West line of said tract 9.63 chains; thence South
87° 25' West 49.45 chains to a stake in center of County Road, in line with
South yard fence on premises formerly owned by Wm. Goffrier; thence South
5° 30' West along the center of the County Road 32.63 chains to a point
where center line of County Road intersects South line of the D.L.C. of

Century Farm- 1918 – 2018

In December of 1918 Henry W. Jones and his wife Minta purchased the farm along the South Yamhill River, four miles west of Amity, where four generations have since farmed the land. They moved from Henry's father's original homestead, which Thomas T. Jones established in 1847 in the foothills about 7 miles south west of McMinnville. This is an area known as Muddy Valley, where there was an abundance of forage grass & water, which worked well for raising livestock. The present farm location is much better suited for raising crops. Excellent soils, farm drainage and irrigation water from the South Yamhill River make for a highly productive farm today.

Henry and Minta had two children, a son and a daughter. The son, Russell was born in 1907 and graduated from Amity High School in 1925. After graduation he worked with his parents on the farm until his marriage to Harriet in 1930. After their marriage, they lived on and rented adjoining farmland.

Henry Jones died in 1939 and shortly thereafter Minta moved to McMinnville. Russell and Harriet then moved onto the farm and raised their five children. They continued to improve the farm and built a new house in 1951. All their children helped out with different tasks on the farm. The oldest son, William bought a neighboring farm north of the Jones farm in 1960.

Youngest son Steven was born in 1949. He remembers helping tend the sheep, tying wool fleeces during shearing and then going into the 8 foot tall wool burlap bags, having the tied fleece dropped down on him as he packed his way to the top of the bag.

A big change to the farm came in 1961 with the addition of an irrigation pump, aluminum pipe, and a big Vermeer sprinkler that was moved with a tractor. The cropping program then was changed to add red clover to the rotation of wheat, barley, vetch, peas and annual rye grass. Hay from the clover was baled in June and sold to dairy farms in Lincoln and Tillamook counties. Then the fields were irrigated and seed was combined in October.

Steve participated in 4-H, FFA and graduated from Amity High school in 1967. After graduation he attended Clatsop Community College in Astoria for one year, then transferred to Oregon State University for his sophomore year. The farm life was more appealing than college classes, so in the fall of 1969 Steve started to rent the Jones farm and his parents began traveling to Arizona for the winters.

The following spring brought another major change in the farm operation with Steve and some other neighboring farmers deciding to put up their own grain storage tanks. They were ordered, concrete foundations poured, and then farmers and their families put up the metal tanks themselves. A portable auger was purchased for filling and loading out the grain. This also changed how the grain was sold and shipped to market.

In 1972, Steve bought the farm and the following year he married Gretchen, a 1969 graduate of Amity High School. They have resided there ever since, raising their four children, two boys and two girls. In the early years

both Steve and Gretchen drove tractors while the kids at times played in the dirt or pasture that adjoined the fields. We also hired babysitters to care for the children at times.

During harvest Gretchen & Steve drove swather, Gretchen drove combine and Steve dumped grain trucks. Steve's father also helped until his health no longer allowed him to help. As the kids got older, they took turns in the combine or riding in the truck with us.

In 1977 was the addition of an elevator leg and cleaner building with seed cleaning machines for processing grain and clover seed. Also this enabled us to fill the grain tanks with the elevator leg.

Early crops were crimson, white and red clover, wheat, oats, alfalfa and silage corn. Irrigation was changed from the Vermeer sprinkler that went to brother William's farm to 3 inch hand lines. Everyone helped move irrigation sprinklers. After the second year the kids wanted to put some of their summer wages towards the purchase of a wheel line, but that didn't happen.

1989 brought the change in crops with the addition of perennial grass seed. We started with Tall Fescue and later added Perennial Rye Grass. This also brought additional cleaning machines to the warehouse and the hiring of a full time employee.

After our kids got their driver's licenses, they each worked off the farm or for neighboring farmers for different experiences. They also helped on the farm as needed. As they got older they went on to their various careers, some leaving the farm, but coming home to help if and when needed.

During high school, oldest son Ryan worked for a local straw baling crew, operating the bale wagon. He graduated from Amity High School in 1992 and attended Chemeketa Community College for a year. He then worked for a manufacturing plant in McMinnville, but in 1995 he decided to start farming. He rented some neighboring property, and also purchased a new bale wagon to do custom stacking. In the fall of 1995 he married his wife Stacie, a 1993 graduate of Amity High School. He operated his stacking business for several years while also farming with his parents. With the birth of their son Nathan in 1999, Ryan sold his stack wagon and farmed full time with his parents. They also have a daughter Lindsey who along with Nathan run equipment during harvest. Nathan graduates from Amity High School in 2018 and Lindsey is finishing her freshman year.

In 2008 a small hazelnut orchard was added. Ryan was instrumental in this decision and getting it established. It was irrigated with the 3 inch hand lines for several years. In 2017 a drip irrigation system was installed and Ryan began planting newer, better varieties amongst the older trees.

In the fall of 2017 Steve & Gretchen rented the home place to Ryan & Stacie and started the process of retiring. Steve and Gretchen are building a home on the adjoining property they purchased from Steve's brother William. Ryan, Stacie & family plan move to the farm, when Steve & Gretchen are relocated.

