

CFR 1098

Thomas W. Gilliland Trust

CFR 1098

Century Farm & Ranch Program Application

Date _____

Type of designation (please check) ☒ Century Farm ☐ Century Ranch

Legal owner's name Thomas W. Lilliland, Disclaimer Trust, Iris B. Lilliland Trustee

(Please attach contact information if different than legal owner)

Mailing address Redacted for Privacy

Telephone Redacted for Privacy E-mail address Redacted for Privacy

County Umatilla Location of farm or ranch (distance from nearest town) Redacted for Privacy
east of Pilot Rock, Oregon

Township 1S Range 32E Section 14

Original family owner(s) or founder(s) Thomas Pence Lilliland

Date (year) this farm or ranch was acquired by founder(s) 1903/1905
(Attach verifying documentation. See Application Qualification #7)

Founder(s) came to Oregon from Colordado

Who farms or ranches the land today? T. Ted and Donna C. Lilliland

Relationship to original owner (See Appl. Qualification #5. Please explain lineage) Son and daughter-in-law

Are any of the original buildings still in use? ☒ Yes ☐ No Listed on National Register? ☐ Yes ☒ No

If yes, please describe The barn is used for feed storage.
The house is lived in by a grounds and house caretaker.

History of crops or livestock raised on farm or ranch (use additional pages, as needed) Wheat, barley,
hay, swine, horses(work), sheep, and cows.

How many generations live on the farm or ranch today? One

Please list names and birth years T. Ted Lilliland 4/1/45

[Please submit two or three pages of family history narrative, including, but not limited to generational transfers of the farm or ranch. You are also encouraged to submit photos of the property.]

(Please continue application on next page.)

Statement of Affirmation

I, Iris B. Gilliland,
hereby affirm and declare that the farm or ranch which I ^{am trustee} own at
Pilot Rock, in the County of Umatilla
has been owned by my family for at least 100 continuous years, as specified in the qualifications for the
Century Farm & Ranch Program, on or before December 31 of the current calendar year. Further, I hereby
affirm that this property meets all other requirements for Century Farm or Ranch honors, including that the
farm or ranch has a gross income from farming or ranching activities of not less than \$1,000 per year for
three out of the five years immediately preceding making this statement. I understand that the application
materials will become property of the Oregon Historical Society Library and be made available for public
use. By signing below, I understand that I am consenting to the use of both information and photographs.

Thomas W. Gilliland Disclaimed Trust
Signature of Owner

Date

2/15/05

Iris B. Gilliland, Trustee

Certification by Notary Public

State of Oregon

County of Umatilla

Be it remembered, that on this 15th day of February, 2005, before me, the
undersigned, a Notary Public in and for said county and state, personally appeared the within named
Iris B. Gilliland, known to me to be the identical individual described in and who
executed the within instrument and acknowledged to me that Iris B. Gilliland executed
the same freely and voluntarily.

In Testimony Whereof, I have set my hand and affixed my official seal the day and year
last above written.



Kandiz M. Snively
Notary Public for Oregon

My Commission Expires Oct. 12, 2008

Fees

Application Fee
(includes one certificate)

\$ 50.00

Additional Certificates (\$15 each)

\$ 15.00

Total enclosed

\$ 65.00

Make checks payable to:

Oregon Agricultural Education Foundation or OAEF

For office use only

Date Received

4-6-05

Approved?

☐ Yes ☐ No

Authorization

Century Farm & Ranch Program Coordinator
OHS Library

MSS 1604 Program ID No. _____

#65- received 4-6-05
2 certificates
✓ #1616

Oregon Agricultural Education Foundation

Century Farm & Ranch Program Application Guidelines

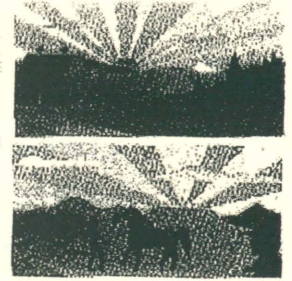

Background

The Century Farm & Ranch Program started in 1958, on the eve of the Statehood Centennial Celebration, to honor farm and ranch families with century-long connections to the land and recognize Oregon's rich agricultural heritage. The program is administered through the Oregon Agricultural Education Foundation and partially funded through a partnership with the Oregon Farm Bureau, Oregon Department of Agriculture, and the Oregon Historical Society. All applications are added to the Oregon Historical Society (OHS) Library and provide valuable information about settlement patterns, livestock and crop choices, building design, and family history. Successful applicants receive a special certificate, with acknowledgement by the governor of Oregon and the director of the Oregon Department of Agriculture. A metal roadside sign identifying their historical Century Farm or Century Ranch property is also available at the owner's expense.

Qualifications

1. Only the legal owner(s) of the property may apply for the Century Farm or Century Ranch honor.
2. Your farm or ranch must have been operated continuously in the same family for 100 years or more. A farm or ranch settled any time 100 years ago or earlier will be eligible if it meets other requirements
3. The farm or ranch must have a gross income from farming or ranching activities of not less than \$1,000 per year for three out of the five years immediately preceding the application.
4. You must live on the farm or ranch, or if you live off the property, you must actively manage and direct the farming or ranching activity on the land. If the entire farm or ranch has ever been rented or leased, it may not qualify.
5. The line of ownership from the original settler or buyer may be through children, siblings, or nephews and nieces. Adopted children will be recognized equally with other descendants.
6. Applications must be submitted on official forms provided by the Century Farm and Ranch Program with all questions completed. Applicants must submit additional descriptive information on other family history details not specifically requested in the application (**two or three pages of narrative**). Copies of historical photographs are encouraged. All information, including photos, will be deposited in the OHS Library for future reference.
7. All applications must include verification of continuous ownership for 100 years. Acceptable forms of proof include a document (either original or photocopy) showing date of earliest ownership. This may be provided through a Donation Land Claim, Deed of Sale, or Homestead Certificate. Other records, subject to review, include Family Bible, diary entry, or correspondence.
8. Applications must be signed and certified by a Notary Public.
9. Deadline for returning applications is **June 1** of the current year. All applications postmarked by midnight of that date will be considered.

Fees

A \$50 non-refundable fee is required with each application. This fee covers administrative costs and includes one certificate. Additional certificates may be ordered at the time of application @ \$15 each. Make checks payable to **Oregon Agricultural Education Foundation** or **OAEF**.

Where To Send Completed Application Packets

When you have completed the form and gathered the necessary documentation, please send the pages titled **Application** and **Statement of Affirmation** and your documentation, with fee payment, to:

Century Farm & Ranch Program
Oregon Agricultural Education Foundation
3415 Commercial Street SE
Salem, OR 97302

(Suggestion: Make a file copy of your completed application form before mailing.)

Review Process and Notification

All applications are checked for completeness by the program coordinator. They are reviewed in June by the Program Board. Following the review, all applicants will be notified about their status by mail.

Honoring Ceremony

Successful applicants are invited to a special ceremony at the Oregon State Fair in Salem and receive a certificate, with acknowledgement by the governor of Oregon and the director of the State Department of Agriculture. The certificate has the name of the farm or ranch in calligraphy and is suitable for framing (11 x 14 inches).

Still Have Questions About the Program?

Please contact **Glenn Mason, Program Coordinator**, at **503-297-5892** or orcentury@juno.com

Note: A source to help you research a farm or ranch history, American Farms: Exploring Their History, written by R. Douglas Hurt, published by Krieger Publishing Co., Malabar, FL, originally printed in 1996, is available at some Oregon libraries or through interlibrary loan.

Thomas Pence Silliland, who purchased the farm in 1904 came from Ukiah, Oregon, where he had been one of the first settlers on Camas Prairie near Ukiah, Oregon. Thomas Pence came to that valley from Colorado in 1880 and engaged in the stock business. In 1892 he was elected County commissioner of Umatilla County and re-elected in 1894; the eighth year of his service ending July 1, 1902. At 44 years old he and his wife had six children. He owned 800 acres of land near Ukiah, had 160 cattle and 16 horses. He conducted a dairy of 30 cows and selling cream to the cream factory. He was one of the most prominent and popular citizens of Umatilla County. (Some of this information came from article from "Scenes and Citizens of Umatilla County")

Prior to moving to Ukiah when he was 22, Thomas Pence had lived in Colorado from the time he was 2 until the family moved to Oregon. Thomas Pence's father was John Silliland a farmer, brick mason and Methodist-Episcopal minister. His mother was Martha (Thorne) Silliland; a homemaker, as most mothers were in the 1800's.

Thomas Pence met Fannie Bolin and they were married by his father Rev. John Silliland on the 10th of December, 1882, at the house of her father, Christopher Bolin.

When Thomas Pence and Fannie moved to Pilot Rock, Oregon, their family included Stella (21), Lewis (18), Todd (17), Paul (14), Bayard (12), and Mamie (9).

The Silliland brothers farmed with horses in the early 1900's.

Swine and sheep were livestock that were raised on the farm along with a few cows.

Two of the original buildings still on the farm are a barn which was in use until 1996, and the house which has been remodeled a few times. The barn is now used to store feed for animals.

Thomas Pence who was a county commissioner as well as a farmer in Umatilla County was also a county judge for 5 years. Thomas Pence died in 1936. His wife, Fannie, lived until 1948.

Bayard Gilliland, Thomas Pence and Fannie's youngest son continued to farm on the farm near Pilot Rock. He married Iona Dawn Perrin and they had two children, Thomas W. and Betty.

Bayard also farmed with horses, raised wheat, and livestock consisted of swine, sheep, and cows.

Thomas W. Gilliland was born in Pendleton, Oregon, and grew up on the farm, attending grade school at the school house located at the end of the farm on the north side.

Thomas W. met Iris Powell who was employed by the Maurice Roy Garage Establishment in Pilot Rock. Thomas and Iris were married in 1939 and Iris gave up her secretary position to become a full time farmer's wife. This involved cooking harvest meals during the summer months. Thomas and Iris were parents of two children, Beverly and Thomas Theodore (Ted).

Thomas W. farmed with his dad, Bayard until Bayard passed away in 1977. They had raised wheat. Continued to raise swine, sheep, and a few cows. They also grew grass to make into hay which was chopped and fed to the sheep.

Ted grew up on the farm, attended school in Pilot Rock, received his associate degree from Blue Mountain Community College, worked for Stanger's Auto Supply in Pendleton, Oregon, and Pendleton Drain Showers in Pendleton and Hermiston, Oregon, until 1979 when he returned to farm.

Ted met Donna Lane in junior high school at Pilot Rock and they married in 1964. Donna was employed by Georgia Pacific for 5 years and then became a

a stay-at-home-homemaker and mom in 1967 with the arrival of AnnMarie, Ted and Donna's, first baby. Matthew arrived in 1969 and Kimberly arrived in 1971.

AnnMarie (12), Matt (10), and Kimberly enjoyed the farm life with helping feed sheep, milk the cow, and drive truck during harvest, and participate in 4-H activities.

Ted helped his dad farm for a couple of years and then his dad retired in 1981 and Ted became a fulltime farmer (his life long dream). Ted increased the sheep flock to 120 ewes of Columbia-Suffolk Cross. The cow herd grew to 30 cows by the year 2000.

The farm has been good to four generations of Gilliland's. The generations grew up on the farm from 1904 to the present, had a home to live in, grew food from the garden, and animal's for meat. The adults and children enjoyed the beautiful quiet place to live.

With the drought conditions that the county has been experiencing for a few years, the cow herd was reduced to 18 in 2004. Ted signed the farm ground up for the CRP program in 2002 and this would enable Ted to continue with some farm operations and not continue to raise wheat at reduced income.

The bottom land is irrigated and used to pasture the cows so Ted will continue to raise cows.

The future plan is to work on raising more profitable crops so Matt, Ted's son, can someday farm as the generations before him.



Thomas Pence, Lewis, Todd, Paul, and
Stella. Lady in back is Martha (Thorn)
Gilliland. (Thomas Pence's Mother).
Picture taken in 1890.

Bolin

Fannie Elizabeth

b.7/30/1856 Clarke Co.,Io.
d.9/7/1948 Pendleton,Umatilla Co.,Or.
m.12/10/1882 Ukiah, Umatilla Co.,Or.
b.2/12/1858 Iowa
d.8/1/1926
bu.Pendleton, Umatilla Co.,Or.

Thomas Pence Gilliland

Children:

Stella May (10/10/1883), Lewis Pence (7/28/1885), Robert Todd (11/14/1887), Paul Strong (4/27/1890),*Bayard Wayne (7/27/1892), Mamie (5/14/1895)+o(4/29/1904).



Fannie crossed the plains in 1872 leaving Arkansas May 9, 1872, and arriving in Marion County, October 12, 1872. Fannie stated in a newspaper article printed on her 90th birthday that she remembered some buffalo coming close to camp. Fannie and her family moved to Umatilla County in 1881. At Ukiah, Oregon, Fannie married T.P. Gilliland in 1882 and lived there for 20 years. Fannie liked horse riding and helping with the ranch work. The six children were born at home with the help of friends.

RANGE 32 E.

MERIDIAN

1 1/4 inches to 1 mile

32
6
192

Map showing
farm
T.P. Gilliland
purchased.

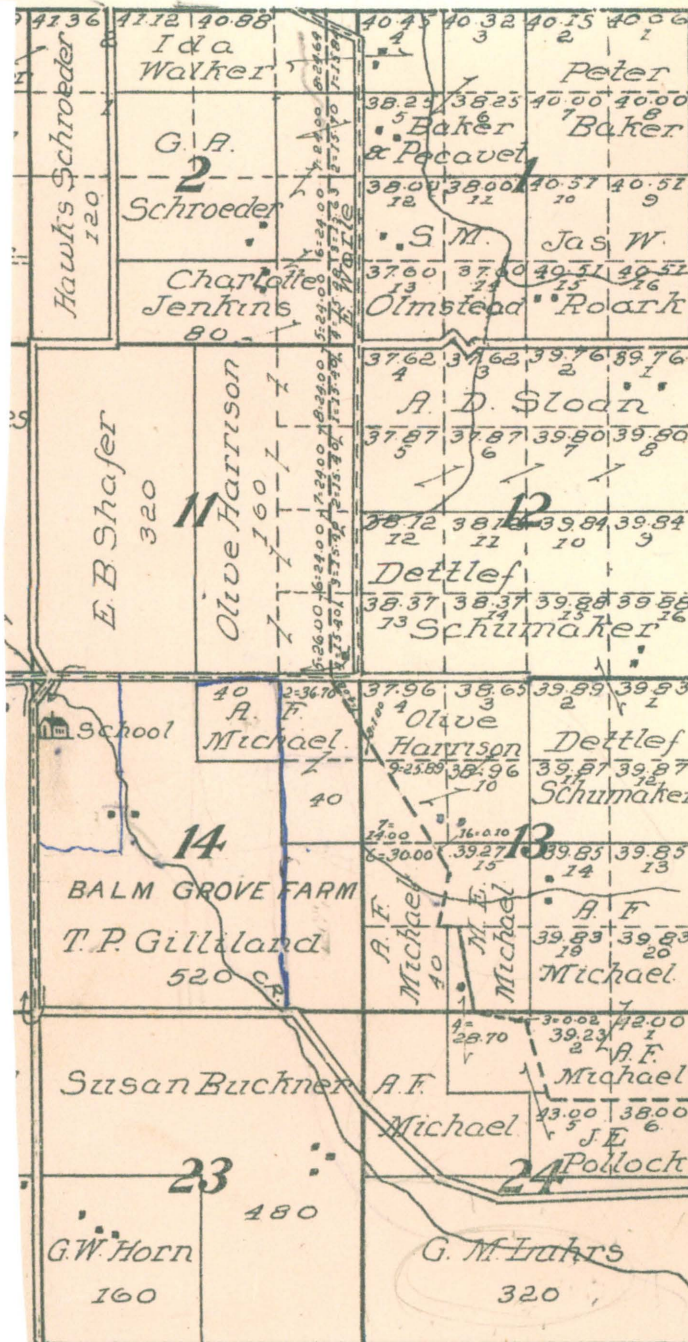



L.N.
Thomas Pence Gilliland and swine at
Pilot Rock Farm.

1915



Lona (Perrin) and Bayard Gilliland

Children of Bayard and Lona



Thomas W. Gilliland



Betty J. Gilliland



Gilliland Brothers: Tod, Bayard, Paul, and Lewis. Harvesting wheat with machine pulled by horses in early 1900's.

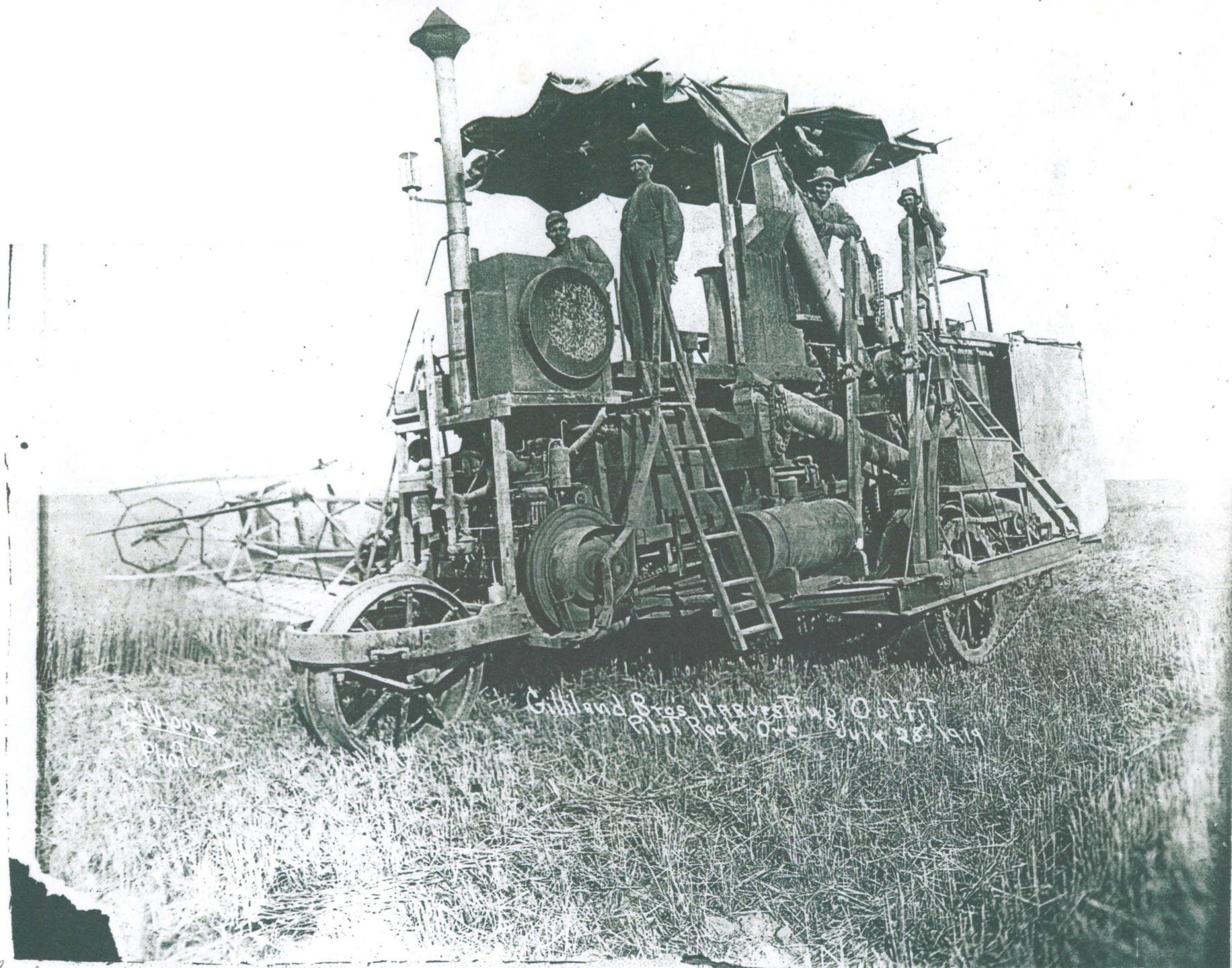

C. Moore
Photo

Gilliland Bros. Harvesting Outfit
Pilot Rock, Ore. July 28, 1919

July,
1919.

Gilliland Brothers' self-propelled combine, Pilot Rock. From left Bayard, (family friend) Sam Walker, (brother of Bayard's wife) Forest Perrin, and Tod Gilliland.



Farm House on the Gilliland
land near Pilot Rock, Oregon.
Picture taken in early 1900's.

Lilliland Farm near Pilot Rock, Oregon, in early 1900's.





Bayard Gilliland farming with horses
in 1920's.



Tom and Iris (Powell)
Silliland
Married at minister's home
in 1939



Thomas Pence and
Fannie (Bolin) Lulliland



Home of
Ted &
Donna
Lilliland
←

←
Home of
Tom &
Iris
Lilliland

View from Air of Lilliland Farm in about 1987.



Sheep on the Gilliland Farm in 1990's

Ted and Donna and Ted's sister and brother-in-law hosted the 50th anniversary for Tom and Iris.



Ann Marie, Matt, Ted, Donna, Tom, Iris,
and Kimberley Gilliland



Beth, Bev, Jennifer, Bob Peterson, Bill Donaldson,
Tom, Iris Gilliland, Amy (Peterson) Donaldson, Ken
Peterson



The farm was the host area for people to stay for many high school graduations, births, birthdays, Christmas, and anniversaries.

Ted and Donna celebrated their 40th anniversary in 2004. Family and friends attended the event in Pendleton, Oregon, 15 miles from the farm with some family members returning to the farm to stay and visit.

Ted and Donna Lilliland's family at their 40th anniversary.
 Jim York, Steve Hardin, Matt Lilliland
 Kim York, AnnMarie Hardin, Phoebe, Stacy Lilliland
 Conner York, Ryan York, Donna, Ted, Cooper, Reese Lilliland
 Sarah Hardin, Dylan York, Heath Lilliland

L. A. Vogal et ux

TO

J. P. Gilliland

Warranty Deed.

Know all Men by these Presents, That L. A. Vogal also known as Lewis A. Vogal and Lydia Vogal, his wife
 of the County of Umatilla State of Oregon, in consideration of
 to them paid by Nine Thousand & # Dollars,
J. P. Gilliland

of the County of Umatilla State of Oregon, have bargained
 and sold, and by these presents do GRANT, BARGAIN, SELL and CONVEY unto said
J. P. Gilliland his heirs and assigns, all

the following bounded and described real property, situated in the County of Umatilla and State of Oregon:

The South Half of Section Fourteen; the West Half of the Northwest Quarter, the Southeast Quarter of the Northwest Quarter and the Southwest Quarter of the Northwest Quarter, Section Fourteen; in Township One South Range Thirty Two, East of the Hellamette Meridian

Together with all and singular the tenements, hereditaments and appurtenances thereunto belonging or in any wise appertaining, and also all their estate, right, title and interest in and to the same, including dower and claim of dower.

To have and to hold the above described and granted premises unto the said

J. P. Gilliland his heirs and assigns forever. And L. A. Vogal and Lydia Vogal

grantor S. above named do covenant to and with J. P. Gilliland the above named grantee his heirs and assigns, that the above granted premises are free from all incumbrances.

and that they will, and their heirs, executors and administrators shall warrant and forever defend the above granted premises, and every part and parcel thereof, against the lawful claims and demands of all persons whomsoever.

IN WITNESS WHEREOF, They the grantor S. above named, hereunto set their hand & seal S. this 15th day of April A. D. 1903.

Signed, sealed and delivered in presence of

L. H. Held
C. R. Rumm

L. A. Vogal

(SEAL.)

Lydia Vogal

(SEAL.)

(SEAL.)

(SEAL.)

STATE OF OREGON,

County of Umatilla ss.

THIS CERTIFIES that on this 15th day of April

A. D. 1903, before me, the undersigned, a Notary Public in and for the said County and State, personally appeared the within named L. A. Vogal and Lydia Vogal, his wife

who are known to me to be the identical person S. described in and who executed the within instrument, and acknowledged to me that they executed the same freely and voluntarily for the purposes and uses therein mentioned.

IN TESTIMONY WHEREOF, I have hereunto set my hand and official seal the day and year last above written.

L. H. Held

Notary Public for Oregon.

Filed for record at 3¹⁵ o'clock P. M., April 15th 1903

Thomas P. Gilliland }
TO
Fannie E. Gilliland }

Warranty Deed.

Know all Men by these Presents, That Thomas P. Gilliland

of the County of Umatilla State of Oregon, in consideration of
and other valuable Considerations One Dollars,
to him paid by Fannie E. Gilliland, his wife

of the County of Umatilla State of Oregon, has bargained
and sold, and by these presents do GRANT, BARGAIN, SELL and CONVEY unto said
Fannie E. Gilliland her heirs and assigns, all

the following bounded and described real property, situated in the County of Umatilla and State of Oregon:

The West Half of the Southeast Quarter, the Northeast
Quarter of the Southwest Quarter, and the South Half of
the Southwest Quarter of Section Three; The Northeast
Quarter, the East Half of Northwest Quarter, the Northeast
Quarter of Southwest Quarter, and the Southeast Quarter
of the Southeast Quarter of Section Four; The North Half of the
Northeast Quarter of Section Five and The West Half of the
Northwest Quarter of Section Ten, All in Township Nine South,
Range Thirty One, East of Willamette meridian

Together with all and singular the tenements, hereditaments and appurtenances thereunto belonging or in any wise appertaining, and
also all his estate, right, title and interest in and to the same, including dower and claim of dower.

To have and to hold the above described and granted premises unto the said

Fannie E. Gilliland, her
heirs and assigns forever. And Thomas P. Gilliland

grantor, above named do & covenant to and with Fannie E. Gilliland the above named grantee her
heirs and assigns, that the above granted premises are free from all incumbrances

and that he will, and his heirs, executors and administrators shall warrant and
forever defend the above granted premises, and every part and parcel thereof, against the lawful claims and demands of all persons
whomsoever,

IN WITNESS WHEREOF, he the grantor above named, hereunto sets his hand and seal this 15th
day of April A. D. 1903.

Signed, sealed and delivered in presence of

L. W. Held

C. G. Reun

Thomas P. Gilliland (SEAL.)

(SEAL.)

(SEAL.)

(SEAL.)

STATE OF OREGON,

County of Umatilla ss.

THIS CERTIFIES that on this 15th day of April

A. D. 1903, before me, the undersigned, a Notary Public in and for the said County and State, personally appeared the within named

Thomas P. Gilliland

who is known to me to be the identical person described in and who executed the within instrument, and
acknowledged to me that he executed the same freely and voluntarily for the purposes and uses
therein mentioned.

IN TESTIMONY WHEREOF, I have hereunto set my hand and official seal the day and year last above
written.

L. W. Held

Notary Public for Oregon.

Filed for record at 4:30 o'clock P. M. April 15th 1903

Chas. F. B. ...

John A. Bradburn
TO
Thomas P. Gilliland

WARRANTY DEED.

Know all Men by these Presents, That *John A. Bradburn*
of *Plot P-11* County of *Umatilla* State of Oregon, in consideration of
Five Hundred (\$500.00) DOLLARS,
to *himself* paid by *Thomas P. Gilliland*
of *Plot P-11* County of *Umatilla* State of Oregon, has bargained
and sold, and by these presents do GRANT, BARGAIN, SELL, and CONVEY unto said
Thomas P. Gilliland his heirs and assigns, all
the following bounded and described real property, situated in the County of *Umatilla* and State of Oregon:

*The North East quarter of the North West quarter of Section
fourteen in Township one South of Range thirty-two East of
Umatilla Meridian in Oregon, containing forty acres according to
the official plat of the survey of the said lands, returned to the
General Land Office by the Surveyor General, which said tract
has been purchased by the said John A. Bradburn, as it appears
on record Oregon Vol. 102, page 393 of the General Land Office*

Together with all and singular the tenements, hereditaments and appurtenances thereunto belonging or in any wise appertaining, and
also all *the* estate, right, title and interest in and to the same, including dower and claim of dower.

TO HAVE AND TO HOLD the above described and granted premises unto the said
Thomas P. Gilliland his
heirs and assigns forever. And *John A. Bradburn* the
grantor above named do covenant to and with *Thomas P. Gilliland* the above named
grantee *his* heirs and assigns, that the above granted premises are free from all incumbrances

and that *he* will, and *his* heirs, executors and administrators shall warrant and
forever defend the above granted premises, and every part and parcel thereof, against the lawful claims and demands of all persons
whomsoever,

IN WITNESS WHEREOF, *7* the grantor above named, hereunto set *—* hand - and seal - this *21st*
day of *January* A. D. 190*5*

Signed, sealed and delivered in presence of
J. E. Beggs
John P. McNamee

John A. Bradburn (SEAL)
(SEAL)
(SEAL)
(SEAL)

STATE OF OREGON,
COUNTY OF *Umatilla* ss.

THIS CERTIFIES that on this *21st* day of *January*

A. D. 190*5*, before me, the undersigned, a Notary Public in and for the said County and State, personally appeared the within named

John A. Bradburn
who is known to me to be the identical person - described in and who executed the within instrument, and
acknowledged to me that *he* executed the same freely and voluntarily for the purposes and uses
therein mentioned.

IN TESTIMONY WHEREOF, I have hereunto set my hand and official seal the day and year last above
written.

John P. McNamee
Notary Public for Oregon.



Filed for record at *8¹⁵* o'clock *A* M., *January 23rd* 190*5*

Wm. J. ...
Recorder of Conveyances.

November 19, 2004

Redacted for Privacy

Century Farm/Ranch Program
Oregon Historical Society - Field Services
1200 S.W. Park Ave.
Portland, Oregon 97205

To Whom It May Concern:

The Gilliland family farm located on Stewart Creek near Pilot Rock, Oregon, was purchased by Thomas P. Gilliland in 1903 (see enclosed copy of Warranty Deed). Fannie Gilliland, wife of Thomas, inherited the land which she left to Bayard Gilliland, son of Thomas and Fannie and part to Thomas W. Gilliland, son of Bayard. When, Bayard died, Thomas W. and his sister Betty Fortier inherited. Betty received 80 acres but Thomas W. continued to farm all of the farm. In 1979 Thomas Theodore, son of Thomas W., moved to the family farm and farmed the land and purchased the 80 acres from Betty and at this time farms all the farm ground. When Thomas W. Gilliland died in 2000, the farm land went into a Thomas W. Gilliland Disclaimed Trust with J. B. Gilliland, wife of Thomas W., as trustee. The language of the will followed into the trust and Thomas Theodore Gilliland and Beverly Peterson, daughter of Thomas W., will inherit the land.

In 1991 Iris (J.B.) Gilliland, wife of Thomas W., had an extensive stroke and at the death of Thomas W., Thomas Theodore received power of attorney over Iris business concerns.

The land has been farmed continually by the Gilliland family since the purchase in 1903 as Thomas P. Gilliland, Bayard W. Gilliland,