

CFR 0879

Daniel Herbert Shaw

OR 0879 UMATILLA
ACK
3/1/94

APPLICATION FOR CENTURY FARM HONORS

Deadline for Filing Application - May 1, 1993/94

(Please type or print)

Telephone #: Redacted for Privacy

Your Name (Mr., Mrs., Ms., Miss) DANIEL HERBERT SHAW

Your Address Redacted for Privacy
Street, Route or Box # City Zip Code

Location of Farm Redacted for Privacy

To qualify as a Century Farm, a farm must have no fewer than 10 acres with a gross income from farm use of not less than \$500 per year for three out of the five years immediately preceding application for Century Farm honors.
Does your farm meet this qualification? Yes.

Name of family member who was founder or original owner of farm: DANIEL SHAW

Founder gained ownership of farm in (Year) 1890
(ATTACH VERIFYING DOCUMENTATION, See Rule 9).

Founder came to Oregon from North Carolina

Who farms the land today? Grandson, Daniel Shaw & Great Grandson, Jeffrey Raymond Shaw
Relationship to original owner As above

Are any of the original buildings still in use? Yes ^{STORAGE}
If yes, which ones? 1/2 barn removed in 1950; (meat house; milk house)
If you know crops or livestock raised on farm one hundred years ago, please list: 1,400 apple trees; 300 hogs; 100 acres alfalfa; cattle; sheep; horses; tried raising popcorn & peanuts; early-on raised vegetables; picked & cleaned 3 a.m.; drove wagon of vegetables to Meacham; sold to the hotel; came back with poles for building fence.
What do you raise on the farm today? Barley; wheat; cattle.

How many generations live on the farm today? Two; Jeff's house on land purchased later.
Please list names: Daniel Shaw.

Do you declare that the statements made above are accurate and correct to the best of your knowledge? Yes

Daniel Herbert Shaw
Signature of Owner

Please return forms to: Century Farm Program
Oregon Historical Society
1200 S. W. Park Avenue
Portland, OR 97205-2483

STATEMENT FORM

I, DANIEL HERBERT SHAW
(Print Full Name)

hereby affirm and declare that the farm which I own at
Rt Redacted for Privacy
(Full Address)

in Umatilla County,

shall have been owned by my family as specified in Rule 2 of the
RULES FOR 1993 CENTURY FARM PROGRAM for at least one hundred
years by no later than December 31, 1993.

Daniel Herbert Shaw
Signature

- - - - - Acknowledgement (for use of Notary Public) - - - - -

STATE OF OREGON

County of Umatilla

BE IT REMEMBERED, That on this 6th day of December,

1993, before me, the undersigned, a Notary Public in and for

said County and State, personally appeared the within named

Daniel Herbert Shaw

known to me to be the identical individual described in and who

executed the within instrument and acknowledged to me that he

executed the same freely and voluntarily.

In Testimony Whereof, I have
set my hand and affixed my
official seal the day and
year last above written.

Debra A Ryan
Notary Public for Oregon

Commission Expires 8-3-96

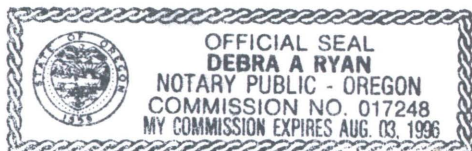

My understanding is that the early settlers didn't file their homestead deeds for some time after they received them . . . carried them around in their pockets because they didn't want to pay taxes. ????

The United States of America.

Umatilla Lands
Certificate No. 69

To all to Whom these Presents shall Come—Greeting:

WHEREAS Daniel Shaw of Umatilla County Oregon
has deposited in the General Land Office of the United States a
Certificate of the Register or the Land Office at Seaside Oregon
whereby it appears that full payment has been made by the said Daniel Shaw

according to the provisions of the Act of Congress of the 24th of April, 1820, entitled "An Act Making Further Provision for the Sale of the Public Lands," and the acts supplemental thereto, for the Lots numbered one and two and the East half of the North East quarter of Section twenty three in Township one North of Range thirty two East of Willamette Meridian in Oregon, containing one hundred and thirty-eight acres, and fifty-nine hundredths of an acre

according to the Official Plat of the Survey of the said Land, returned to the General Land Office by the Surveyor General, which said tract has been purchased by the said Daniel Shaw

NOW KNOW YE That the United States of America, in consideration of the premises, and in conformity with the several Acts of Congress in such case made and provided, have Given and Granted and by these presents do Give and Grant, unto the said Daniel Shaw and to his heirs, the said tract above described;

TO HAVE AND TO HOLD the same, together with all the rights, privileges, immunities and appurtenances, of whatsoever nature, thereunto belonging unto the said Daniel Shaw and to his heirs and assigns, forever; subject to any vested and accrued water rights for mining, agriculture, manufacturing or other purposes, and rights to ditches and reservoirs used in connection with such water rights, as may be recognized and acknowledged by the local customs, laws and decisions of Courts, and also subject to the right of the proprietor of a vein, or lode, to extract and remove his ore therefrom, should the same be found to penetrate or intersect the premises hereby granted, as provided by law.

IN TESTIMONY WHEREOF, I Grover Cleveland President of the United States of America, have caused these Letters to be made Patent, and the Seal of the General Land Office to be hereunto affixed.

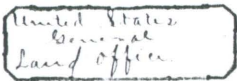

Given under my hand, at the City of Washington, the Twentieth day of June in the year of our Lord one thousand eight hundred and ninety-three and of the Independence of the United States the one hundred and seventeenth

BY THE PRESIDENT: Grover Cleveland
By E. Macfarland Asst. Secretary.

Recorded Vol. 130 Page 359 L. L. C. Lanier Recorder of the General Land Office.

Filed for Record at the request of at 1:20 o'clock P. M.

July 5th A. D. 1892

By W. Vaclandigham Deputy.

Wm. Folsom
Recorder of Conveyances

Dad and Mother

November 12, 1891, Dad hired a livery team in Pendleton,
and they were driven out to their home. It was snowing. They had
been married the day before in La Grande, at the home of Uncle John
and Aunt Mag. Mother had a dress of fine brown cashmere and a tiny
brown bonnet for her wedding. The ranch was 9 miles south of
Pendleton, on McKay creek. Dad had bought it the year before, when
some of the Umatilla reservation land had been sold to settlers,
paying \$1.25 per acre. He bought 160 acres and had to live on it one
year, before getting a deed. There was a three room house, and
Mother papered the walls with newspapers, and she had no curtains the
first year, but she said she kept the windows so shingling clean, that
she didn't mind in the least. They raised large vegetable gardens
the first years, and they would load the lumber wagon with vegetables
at night, then before daybreak, Dad would leave for the Blue Mountains,
where there was a sawmill. He would sell or trade for lumber and that
was how they got lumber to build the first barn. He planted 1400 apple
trees, most of them Ben Davis, a few Northern Spies (Mother's favorite)
Snows, Bellflowers, and Pearmanes. The orchard was bearing by 1900.
They had cows and Mother helped milk and made butter which was sold or
traded to stores for staples. The lumber wagon was all they had to
ride in for several years, and when the spring wagon acquired, Mother
said: "It made my head spin, to go so fast." Robert was born August 17,
1892, and Edwin April 21, 1894. Living so near the creek was a source
of constant worry, with little boys. One afternoon Robbie disappeared.
They looked all along the creek, and finally found him at the far end
of the orchard, fast asleep. Another time it was Ed, and again the
search along the creek, and again, sleeping peacefully under a willow
tree. I was born September 15, 1900, and we were the family.



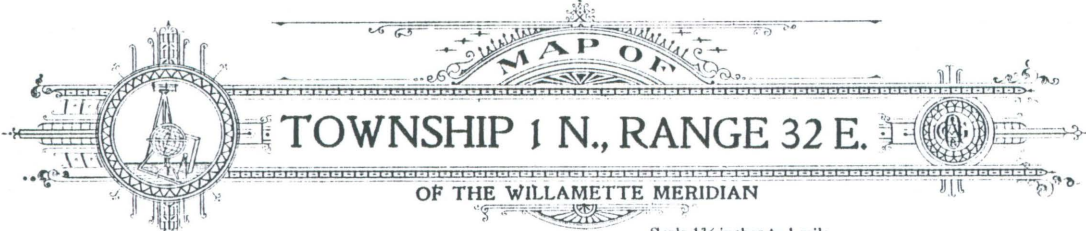

MAP OF

TOWNSHIP 1 N., RANGE 32 E.

OF THE WILLAMETTE MERIDIAN

Scale 1 1/4 inches to 1 mile

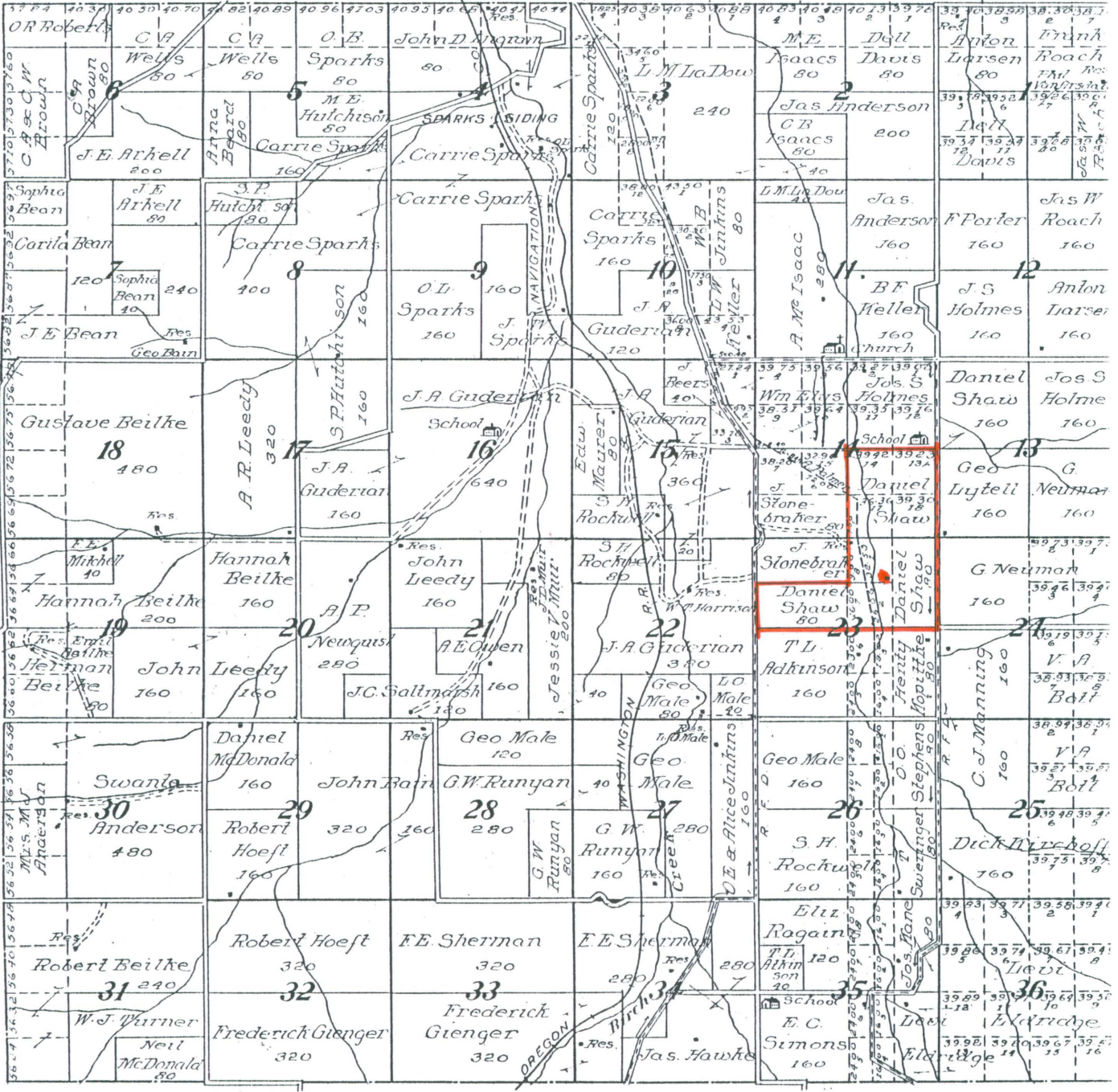

UMATILLA COUNTY

HISTORICAL SOCIETY

P.O. BOX 253 • PENDLETON, OR 97801



0000

U.S. POSTAGE
PNDL
PENDLETON, OR
97801
DEC 15, 1993
AMOUNT

\$0.52
00041738-02

Ron Brentano
Oregon Historical Society
1230 SW Park Ave.
Portland OR 97205

RECEIVED

DEC 20 1993

Oregon Historical Society

*Century Farm
Application*