

CFR 0622

Orvis W. Moore

Received
4 May 98

WALLOWA

X

APPLICATION FOR CENTURY FARM HONORS **1998**

Deadline for Filing Application - May 1, ~~1996~~

(Please print or type)

Telephone #: Redacted for Privacy

Your Name (Mr., Mrs., Ms., Miss) Orris W. Moore

Your Address Redacted for Privacy

Street, Route or Box #

City

Zip Code

Location of Farm Redacted for Privacy

To qualify as a Century Farm, a farm must have a gross income from farm use of not less than \$1,000.00 per year for three out of the five years immediately preceding application for Century Farm honors. Does your farm meet this qualification? yes

Name of family member who was founder or original owner of farm:

WILLIAM A. Moore

Founder gained ownership of farm in (Year) 1897
(ATTACH VERIFYING DOCUMENTATION, See Rule 9).

Founder came to Oregon from Washington

Who farms the land today? Orris W. Moore

Relationship to original owner great grandson

Are any of the original buildings still in use? No

If yes, which ones? _____

If you know crops or livestock raised on farm one hundred years ago, please list: CATTLE, grain

What do you raise on the farm today? CATTLE + grain

How many generations live on the farm today? 1

Please list names: Orris W. Moore

Do you declare that the statements made above are accurate and correct to the best of your knowledge? yes

O.W. Moore

Signature of Owner

Please return forms to: Century Farm Program, Oregon Historical Society
1200 S. W. Park Ave., Portland, OR 97205-2483

CFR0622

STATEMENT FORM

I, O. W. Moore,

hereby affirm and declare that the farm which I own at

Redacted for Privacy

(Full Address)

in WALLAWA County,

shall have been owned by my family as specified in Rule 2 of
the RULES FOR 1995 CENTURY FARM PROGRAM for at least one hundred
years by no later than December 31, 1995.

O. W. Moore
Signature

-----Acknowledgement (for use of Notary Public)-----

STATE OF OREGON

County of Walla Walla

BE IT REMEMBERED, that on this 20th day of April,
1998, before me, the undersigned, a Notary Public in and for
said County and State, personally appeared the within named

O. W. Moore

known to me to be the identical individual described in and who
executed the within instrument and acknowledged to me that he
executed the same freely and voluntarily.

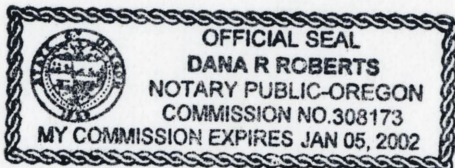

In Testimony Whereof, I have
set my hand and affixed my
official seal the day and
year last above written.

Dana R. Roberts
Notary Public for Oregon

Commission Expires 1-5-02

Know all Men by these Presents, That William N. Merrill and Jessie C. Merrill, husband and wife,

in consideration of the sum of Fifteen Hundred Dollars (\$1500⁰⁰) to them paid by Elizabeth C. Moore

and by these presents do hereby grant, bargain, sell and convey unto the said Elizabeth C. Moore her heirs and assigns all the following real estate, to-wit:

The North West 1/4 of Section Thirty three (33), Township Six (6) North of Range Forty three East of Willamette Meridian, Union Co. Oregon.

Together with the tenements, hereditaments and appurtenances thereunto belonging, or in anywise appertaining; and also all our estate, right, title and interest at law and equity therein or thereto, including dower and right of dower.

To Have and to Hold the Same unto the said Elizabeth C. Moore her heirs and assigns forever. And we the said William N. Merrill and Jessie C. Merrill do hereby covenant to and with the said

Elizabeth C. Moore her heirs, assigns and legal representatives, that the said real estate is free from all incumbrances, except

and that we will, and our heirs, executors and administrators shall WARRANT AND DEFEND the same to the said Elizabeth C. Moore her heirs and assigns forever against the lawful claims and demands of all persons whomsoever.

In Witness Whereof, we have hereunto set our hand and seals this Eleventh day of November A. D. 1897.

Executed in the presence of

W. A. Austin
J. D. Hill

William N. Merrill
Jessie C. Merrill

[SEAL]
[SEAL]
[SEAL]
[SEAL]

STATE OF OREGON,
COUNTY OF WALLOWA. } ss.

This is to Certify, that on this Eleventh day of November A. D. 1897, before me, the undersigned, a Justice of the Peace in and for said County and State, personally appeared the within-named William N. Merrill and Jessie C. Merrill his wife, who are personally known to me to be the identical persons described in and who executed the within instrument, and acknowledged to me that they executed the same freely and voluntarily for the uses and purposes therein mentioned.

In Witness Whereof, I have hereunto set my hand and this Eleventh day of November A. D. 1897.

J. M. Conroy

Received for Record and Recorded

July 3th

at 9 a M. 1900

J. A. Burling County Clerk.
By _____ Deputy.

Know all men by these presents, that William M. Merrill of the County of Wallowa, State of Oregon, for and in consideration of the sum of Five Hundred Dollars (\$500.00) to him in hand paid by Elizabeth C. Merrill, the receipt of which is hereby acknowledged, have granted, sold and conveyed unto the said Elizabeth C. Merrill her heirs and assigns all the following real estate, to wit:

The North West 1/4 of Section 31, Township 35 N, Range 20 E, Meridian 1, Wallowa Co, Oregon

Together with the tenements, hereditaments and appurtenances thereto belonging or in anywise appertaining; and also all other estate, right, title and interest at law and equity therein or therein, including dower and right of dower. So that she and to her heirs and assigns forever. And as the said William M. Merrill do hereby covenant to and with the said Elizabeth C. Merrill her heirs and assigns forever, that the said real estate is free from all incumbrances, except as herein otherwise expressed.

And that the said William M. Merrill will and lawfully shall, his heirs, executors and administrators shall WARRANT AND DEFEND the same to the said Elizabeth C. Merrill her heirs and assigns forever against the lawful claims and demands of all persons whomsoever.

In Witness Whereof, I have hereunto set my hand and seal at Wallowa, this 30th day of April, A.D. 1998.

William M. Merrill
[Seal]
James O. Merrill
[Seal]
[Seal]
[Seal]

Witnessed in the presence of
L. B. Curtis
J. B. Hill

STATE OF OREGON } S.S.
County of Wallowa

I, CHARLOTTE McIVER, County Clerk in and for the said County and State, do hereby certify that the foregoing copy of DEED

records of Wallowa County, State of Oregon, has been by me compared with the original, and that it is a correct transcript therefrom, and of the whole of such original as the name appears of record and on file in my office and in my custody.

IN TESTIMONY WHEREOF: I have hereunto set my hand and affixed my Official Seal, this 30th day of April, A.D. 1998
Charlotte McIVER
COUNTY CLERK

By _____ Deputy

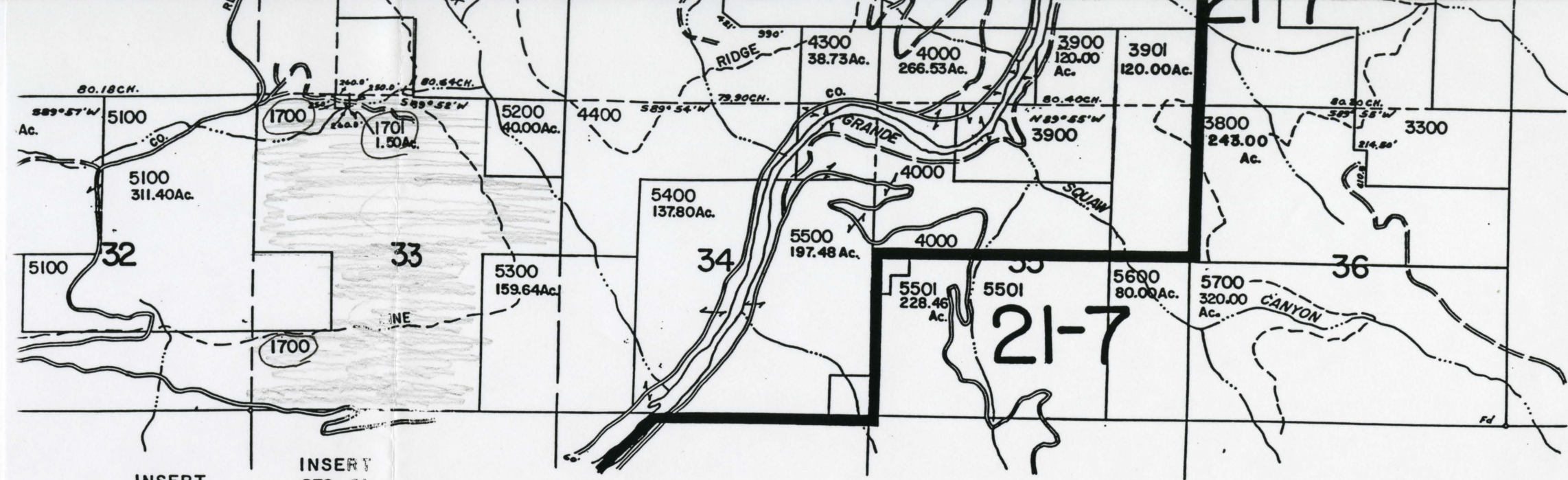

INSERT
SEC. 20
1"=200'

165'
1500
0.50Ac.

INSERT
SEC. 21
1"=200'

NW Cor. Sec. 21

210'
2000
1.00Ac.

CO. RD.

SEE MAP 5N 43

TL 1900
SEC. 28

1. N87°54'E 103' To E of RD.
2. S39°43'E 28'
3. S35°34'E 104.3'
4. S2°26'W 183'
5. S29°37'E 219.4'
6. S57°34'E 43.55'
7. N82°22'E 96.9'
8. N63°26'E 107.4'
9. S41°39'E 98.6'
10. S72°06'E 177.8'
11. S87°07'E 201'
12. S70°59'E 35'
13. S0°12'E 411' To E of RD. leading to Bear Cr.
14. S51°40'W 44'
15. S87°45'W 122.7'
16. N57°54'W 135.6'
17. S75°27'W 177.3'
18. N44°44'W 149.7'
19. S82°06'W 211'
20. N62°32'W 532.2'
21. N88°25'W 78.2'

6N 43

ORVIS W. MOORE

Township No. 06~~N~~43 Range No. Dec 33 Mer.

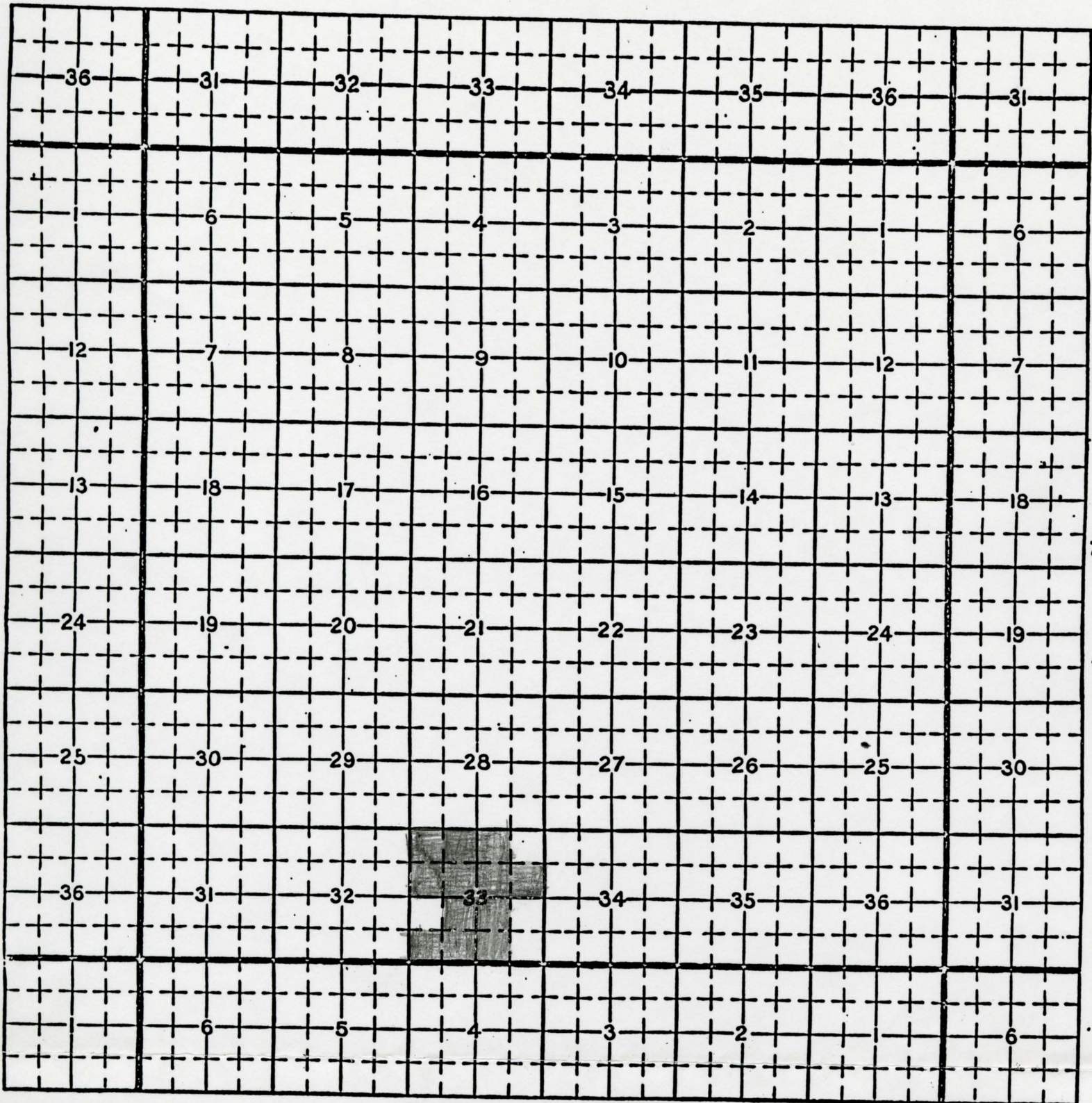

Showing adjoining sections

Scale 80 chains to an inch
0 20 40 60 80

PRESENTLY OWNS SHADED AREA
OF THIS SECTION

mainly visits, way, Califor-

bers and by ke, after 48 parents of six hter Ann and en: Kenneth nifer Eliza- (born 1975). Valerie have born 1968); Joshua Platt Monschke's have three Mae (born 1982). Fourth Marie (born id husband, Todd (born 8). None of ore natural nily gather- much loved

ily of twelve ers, Burnie have often iley.

hke comes ne brother. er Warren mily reun- 2, and 1983 en attend- ways part of

MOORE

Washing- do, first in some gold r where he shal. After nd Shell's the West. vent to the ly, and the ce, contin- Soon John brother in

ill and his ear 1899. ool, while im in the long and horseback

lora, and nver and Mr. and va where

with four iso in the Mr. Shell nited in ir espec- allowa to ming on rider for r a num- ving and her own helping to this

As of this writing (February, 1983) there are two daughters living: Mrs. Emmett (Erma) Landers in Wallowa, Oregon, and Mrs. Kenneth (Beulah) Blue in Greeley, Colorado. Many grandchildren and their families live in scattered parts of the United States. They will never realize the rigors their ancestors endured to leave them the good life many years after Shell and Evelyn departed this life.

ROBERT G. MOORE FAMILY

Robert and Louise Moore and their three grown children moved to Wallowa County in December 1937. Roberta was teaching in Grant County. Jerry had been working in a grocery store and Kirk was still in high school.

Robert's sister, Mrs. Adrian Nodine, her husband and family lived in Wallowa County for a short time. Later Lydia and her husband George Miller lived in Enterprise. He was a lawyer. His wife was a sister to Louise. After a visit, the Moores decided to move to Wallowa County. They auctioned off all their farm equipment and household goods, packed up a van and a car and moved to Enterprise.

Kirk entered Enterprise High School, Jerry worked in a grocery store and Roberta returned to Ritter to finish out the school year.

Louise started teaching at Imnaha in January. Robert rented the Jack Johnson ranch on Sheep Creek and ran it for about five years.

During World War II their sons went to Hawaii to work in construction. Later Jerry and his wife Kathleen moved to southern California. Roberta, after teaching four years in Wallowa County, spent two years in the Coast Guard. Kirk later became a paratrooper. He married Gertrude Marley, who had taught school in Enterprise.

Roberta came back and taught in Enterprise and married Jay Hockett who was also teaching in Enterprise.

During the war Robert bought some property on Sheep Creek and built a cabin and raised a big garden. Louise taught in many of the one room country schools. One year she taught on the Divide and had only one pupil. Robert worked as a carpenter and a roofer for several years.

After retiring, they spent the winters in Arizona and stayed on Bob Swisher's slope ranch in the summer.

Both of the Moores were second generation Oregonians. Both Louise's and Robert's maternal grandparents crossed the plains in wagon trains during the 1840's. Louise was born in a log cabin near Fossil and Robert was born on the Moore ranch on the John Day River.

Robert passed away February 11, 1981. Louise is in a nursing home in Santa Maria, California.

FAMILY OF WILLIAM A. AND AGNES MOORE

William A. Moore and Sam Morrison came into Troy, Oregon, in 1897 to observe the area as a location for a homestead. They spent the winter of 1897-1898 in a small cabin west of Troy, on the Wenaha River. When spring came and the hills were green with bunch grass, they decided the Troy area would be an ideal location to raise cattle. They each filed on a homestead claim in 1898.

The same summer William returned to Waitsburg, Washington, to get his small herd of cattle. He drove the herd from Waitsburg, Washington, through the Blue Mts. by way of the Toll Gate to Wallowa, Oregon, where he found feed and a

place to stay for the winter. The spring of 1899, before the snow was all gone, he took his cattle through the Promise area to the Grande Ronde River Hills, where the grass was beginning to grow. With abundant feed, he went on toward his homestead at Troy.

That spring and summer he built a log cabin, cleared land for farming, built fences, and continued to improve his homestead. He made acquaintance with his neighbors who were few and far between. One acquaintance was a young lady, Agnes Crasland, who was also of a pioneer family in the Troy area. Incidentally William and Agnes were both from the state of Iowa, and both came West with their parents at a young age.

William and Agnes were married in November, 1899, at Clarkston, Washington, and began their married life in the one-room cabin. As time went on they prospered and were able to expand their property holdings.

To this union were born Raymond, Errett, Lydia, Esther, Wayne, and Margaret. There was a great deal of sickness in the family, and the closest doctor was at Flora, Oregon; he was Dr. Gilmore, who made many long trips over the country to care for the sick. With motherly love and care, Agnes always nursed her family back to health.

The children all attended the Fairview District #42 and completed their eight grades. Lydia, Esther, Wayne, and Margaret went on to finish high school at Flora, Oregon. Lydia and Esther became teachers; Margaret, a secretary, worked for the city of Portland until retiring; and Wayne came back to the ranch.

In 1936 William (the father) had the misfortune to get a leg injury which prevented him from carrying on farm work. Wayne and Erma, with their three daughters, took over the home ranch until 1947, when they sold to Raymond and moved to Silverton, Oregon.

Raymond, Myrtle, and their three boys continued to operate the Moore ranch until 1965 when Raymond retired. Orvis Moore took over the ranch at that time; the other two boys, Lowell and Marlin, decided farming wasn't for them and found other occupations.

Errett left the farm when still young. With his wife, Pauline, and three children, they lived at Sandy, Oregon.

William and Agnes spent many years at hard work. They made a good home for their family, while living in a remote area with a limited amount of advantages.

William was born January 20, 1869, and died October 3, 1965; Agnes was born January 18, 1880, and died in 1957; Raymond was born November 24, 1900, and died May 2, 1982; and Errett was born October 15, 1902, and died January 8, 1970. Lydia (Mrs. Carl Keeler) had one daughter; Esther (Mrs. Fred Ramsay) had three children; and Margaret (Mrs. Ray Reed) had two sons.

RONALD V. MORGAN

The Ronald V. Morgan family began 17 years ago in Portland, Oregon. Ron was the son of Leon and Joyce Morgan and was born June 24, 1946. He is the oldest of a brother Leon and two sisters, Diane and Debroah.

Suzanne was the daughter of Harry and Betty Zachor and was born May 29, 1947, in Portland, Oregon. She was the second child of four, a brother Jim and two sisters, Shelley and Debbie.

In 1964 Ron graduated from Benson High School; in 1965 Suzanne graduated from Madison High School.



Ronald V. Morgan Family

In 1965 Ron joined the United States Marine Corp. Upon his return from Vietnam on September 17, 1966, we were married. We lived in Santa Clemente, California, until Ron was discharged from the Marines in 1967. We lived there for a year, then moved to Gresham, Oregon.

In 1968, Anna Elizabeth was born. Kristan Michelle was born. We lived in Gresham for 13 years before moving to Junction City, Oregon. For a number of years, Ron hunted and fished in Wallowa County, always longing to stay. Joseph was the ideal area to raise our children and our dog, Lady, we prayed that the move here would become reality.

Sure enough, in the summer of 1981, Ron was accepted as an employee of the Wallowa Office. On September 21, 1981, he began working for the post office. Felicia began working at the Bank of Wallowa in the bookkeeping department.

Our oldest daughter's freshman year at Wallowa High School has been thrilling. She was to be a member of the State Basketball team, the "E-gals," and set a high jump record, jumping 5'2".

Our youngest daughter is active and recently won second prize in the Poppy contest sponsored by the Wallowa Chamber of Commerce #4307. She also tries hard to out fish in Wallowa Lake.

We are members of Wallowa Valley Church and feel truly blessed to be part of this community.

EMILY JANE MORRIS

I am the great granddaughter of John Reel and Eliza Ellen Reel; the daughter of Percy Henry Smith and Janice and the daughter of Owney Whetstone and K. Whetstone.



Morris Family

I was born at Newport, January 1904. During the depression, our family moved to Wallowa where my father had work. He was worl

WALLOWA COUNTY HISTORY BOOK

Orvis W. Moore
Redacted for Privacy

5 June 1998

Dear Orvis,

It gives me great pleasure to inform you that your **Century Farm** application has been approved. Congratulations on receiving this prestigious honor for the William A. Moore Farm, founded in 1897. A total of 23 farm and ranch owners submitted applications this year and *all* of them met the requirements for Century Farm status. This brings our grand total of Oregon Century Farms to 921 (recognized since 1958 when the program started).

Now that all 1998 applications have been reviewed, we can begin the process of creating the award certificates. These special documents, signed by Gov. Kitzhaber and dignitaries from the Oregon Historical Society, will be available in the late summer or fall.

To recognize your family's accomplishment, it's customary that the certificate be presented in a meaningful way. If you already have an event in mind—such as a special family reunion—please share that information with me so I can have your Century Farm certificate ready by that date (and attend if you wish). The Wallowa County Historical Society may be interested in hosting a certificate presentation ceremony, perhaps during a regular meeting or event, when you and other family members can officially receive your Century Farm certificate. These are just some of the options available to you.

If you are interested in sharing recognition of your honor, you may want to purchase a distinctive "CENTURY FARM" sign for your property. Please see the attached fact sheet for the details. The Oregon Historical Society *does not* sell these signs.

Thank you for participating in this popular, and important, heritage program. If you have any questions about the Century Farm Program, please feel free to call me at (503) 306-5215.

Sincerely,

Rick Read
Field Services Coordinator

cc. Wallowa County Historical Society